

Quick Start Guide

FR1500S

Version: 1.0

1. Overview

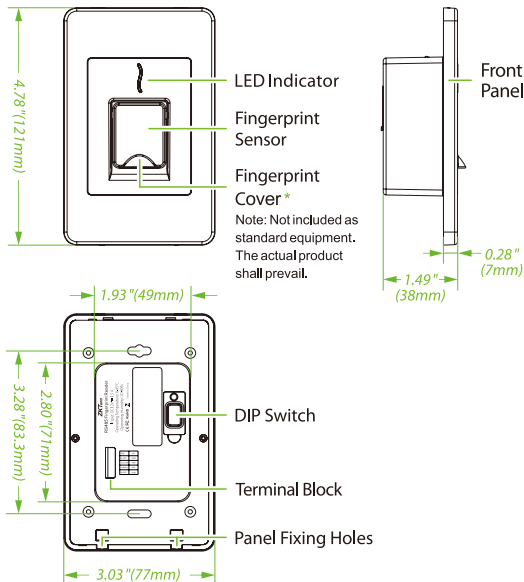

2. Device Installation

Preparation for installation

1. Before installation, remove the two inner-hexagon screws at the bottom of the panel with an hex wrench.
2. And then take out the front panel as shown below.

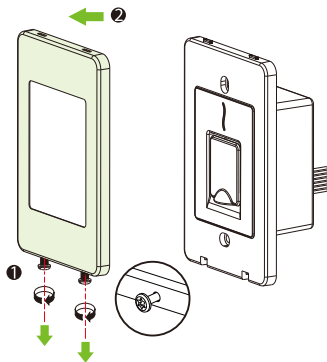

Mounting on the standard single gang junction box

1. Drill holes in the wall at suitable locations according to the holes in the single gang box.
2. Fix the single gang box on the wall with the wall mounting screws.
3. Lay the cables from the desired hole in single gang box and fix the machine part to the box part.
4. Install the panel back into the device and lock the two inner-hexagon screws at the bottom.

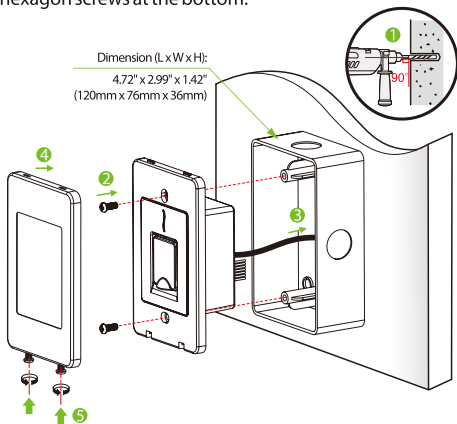



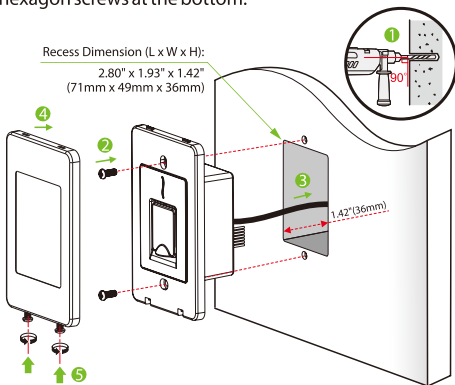

Recessed wall installation

1. Place the mounting sticker to the place where the device needs to be installed.
2. Drill fixing holes and dig mounting groove deep of 36mm.
3. If cables need to be laid from behind then it must be done before installing. And then install the device with the screws.
4. Finally fit the panel back to the device and lock the two inner-hexagon screws at the bottom.

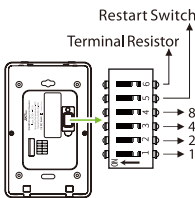

Note: To effectively protect the equipment from water and dust, install it vertically on the ground.

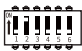
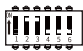
3. DIP Switch Settings

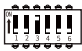
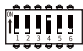
DIP Switch	Address	Switch Settings	Address	Switch Settings
	1		5	
	2		6	
	3		7	
	4		8	

Important Notes:

1. There are six DIP switches on the back of FR1500S. Switches 1-4 is for RS485 address, switch 5 is restart switch, switch 6 is for reducing noise on long RS485 cable.
2. The FR1500S supports OSDP(Ver2.1.7) and ZK-RS485 communication protocols, enabling seamless integration with ZKTeco's advanced access control systems, such as the InBio Pro Plus series and other fingerprint terminals.
3. If the cable length is more than 200 meters or 600 ft , the number 6 switch should be ON, that is parallel a terminal resistance of 120 ohm between 485+ and 485-.

4. Terminal Block

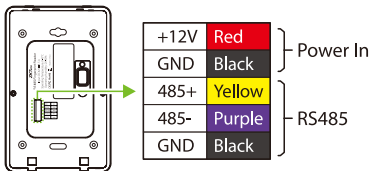

5. Power Connection

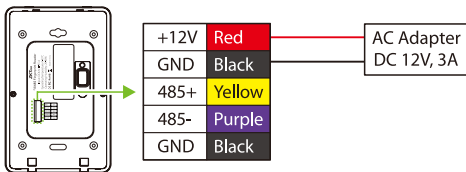

- Recommended AC adapter: **12V, 3A**
- To share power with other devices, use an AC adapter with higher current ratings.

6. Controller Connection

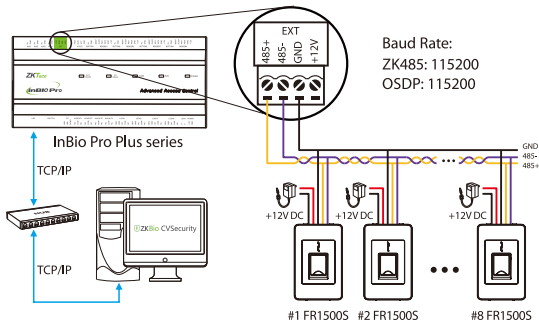

Notes:

1. One InBio Pro Plus can connect to maximum of eight readers.
2. Set the RS485 addresses of each FR1500S by the DIP switch before power is supplied.
3. Each FR1500S reader requires a separate power supply.
4. FR1500S reader supports ZKFingerprint V10.0 (Default) / V13.0 algorithm version, adaptive host controller, host can switch to select the fingerprint algorithm version.

⚠ NOTE: No wiring while powered.

7. Standalone Access Controller Connection

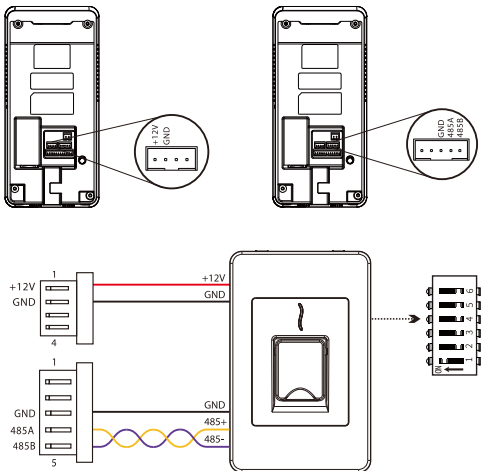

Note: When using the reader with Standalone access controller device, please move the dial code "1" to the ON position as shown above.

8. Verification Process

Operation	Verification Results	LED & BEEP Status Description
Connection with the controller	Unsuccessful	LED flashes blue light twice every one second.
	Successfully	LED flashes blue light once every one second.
When verifying the fingerprint or punching the card	Successful Verification	Green LED lights, short BEEP
	Authentication error	Red LED lights, two short and a long BEEP
	Data Error	Red LED lights, one short and a long BEEP
	Timeout	Red LED lights, four short BEEP
	Authentication failed	Red LED, two short BEEP
	No rights	Red LED, three short BEEP
	Verify unfinished	Red LED flashes three times

Safety Precautions

1. Power cable should be connected at last, after all the wiring. If the device is working abnormally, immediately shutdown the device.
2. Please read the terminals description and wiring by rule strictly. Any damage caused by improper operations will be out of the range of our guarantee.
3. Please connect the 'GND' before all the other wiring especially under the serious electrostatic environment.
4. Keep the exposed part of wire less than 5mm to avoid unexpected connection, and result in machinery damage.
5. If the distance between power supply and device is little long, please do not use the Internet cable or other types of cable instead. When choosing the power supply cable, you should consider that the transmission distance may cause voltage attenuation.

ZKTeco Industrial Park, No. 32, Industrial Road,
Tangxia Town, Dongguan, China.

Phone : +86 769 - 82109991

Fax : +86 755 - 89602394

www.zkteco.com

