

Installation Guide

FaceDepot 4A

Version: 1.0

What's in the Box?

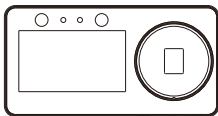

Terminal x 1

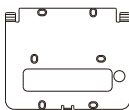

Backplate x 1



Mounting
Template x 1



Expansion Tube x 4
Wall Mounting Screws x 4
Security Screw x 1



12V/3A Adapter x 1



Installation Guide x 1



Connection Cables



Back-up Battery x 1 ★



Magnet x 1

Note:

1. To ensure the accuracy of fingerprint recognition, please remove the fingerprint sensor protective film before using your fingerprint.
2. Not all products have the function with★, the real product shall prevail.

Installation Environment

Please refer to the following recommendations for installation.



INSTALL INDOORS
ONLY



AVOID GLASS
REFRACTION



AVOID DIRECT
SUNLIGHT
AND EXPOSURE



KEEP EFFECTIVE
DISTANCE
0.3 to 2m

How to Install the Device on the Wall?

Step 1: Stick the mounting template to the wall and drill holes according to the mounting template.

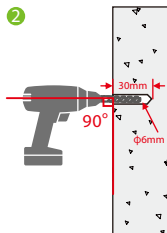
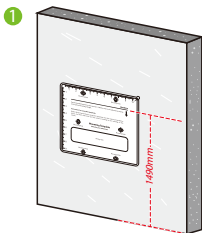

Step 2: Insert the expansion tubes into the mounting holes.

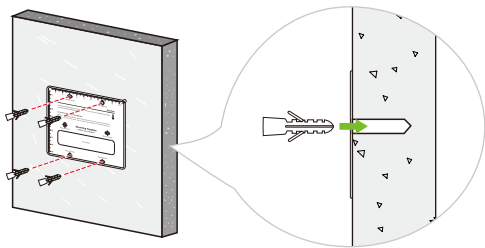

Step 3: Attach the backplate on the wall using the wall mounting screws.

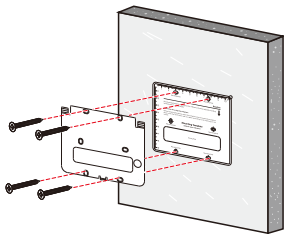

Step 4: Attach the terminal to the backplate.

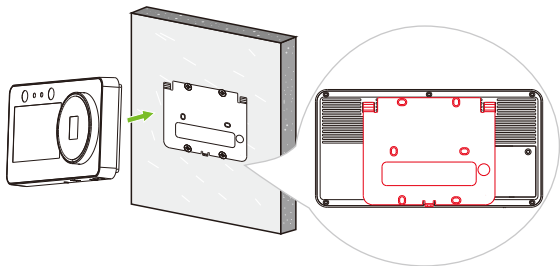

Step 5: Fasten the terminal to the backplate with a security screw.

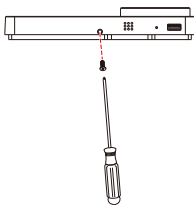

Download Center

Scan the QR Code to download the **User Manual, Installation Guide** and **Quick Start Guide**.



QR Code (Download Center)

ZKTeco Industrial Park, No. 32, Industrial Road,
Tangxia Town, Dongguan, China.

Phone : +86 769 - 82109991

Fax : +86 755 - 89602394

www.zkteco.com

