

# ProRF

## RFID Access Control Terminal



**ProRF** is an elegantly designed RFID access control terminal. Its IP67 waterproof & dustproof level enables direct outdoor installation, and is even able to normally operate under extreme weather conditions in a temperature range of -20°C~65°C.

As an advanced terminal, ProRF is equipped with 2 relays of lock, alarm control, SRB for enhanced security, and auxiliary smoke detection input for fire security linkage. Its large storage capacity of up to 100,000 users/cards and 600,000 transactions is perfectly applicable to mega-size enterprise.

# Features

- IP-based terminal, supports either standalone or network deployment
- IP67 waterproof design, suitable for indoor or outdoor applications
- Operating temperature: -20°C~65°C (-4°F~149°F)
- Full access control features

# Specifications (GL Exclusive Feature)

### Capacity

GL Users / Cards: 60,000 (Standard)  
100,000 (Optional)  
Transactions: 600,000

### Communication

TCP / IP  
RS232 / RS485  
Wiegand Input / Output  
Security Relay Box

### Access Control Interface

Lock Relay Output  
Alarm Output / Auxiliary Input  
Exit Button / Door Sensor  
Doorbell Output

### Hardware

1.0GHz High Speed CPU  
Memory 64MB RAM / 128MB Flash  
  
125KHz EM Reader / 13.56 MHz MF (Optional)  
HID Prox. (Optional)

Beep & LED Indicator

### Standard Functions

Access Levels / Groups / Holidays

### Compatibility

Wiegand Slave Reader  
ZKBioSecurity

### Special Functions

GL IP67

### Additional Info

Working Temperature: -20 °C ~ 65 °C  
(-4 °F ~ 14.9 °F)  
Dimensions: 131\* 80 \* 20.6 mm

### Power

Operating Voltage 12V DC  
Current Draw < 500mA

# Configuration

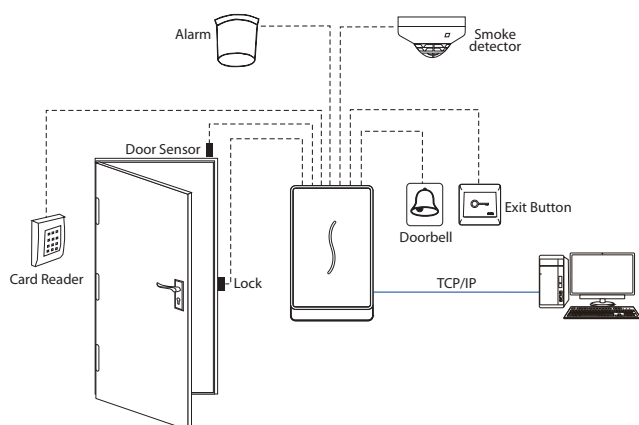

# Dimensions (mm)

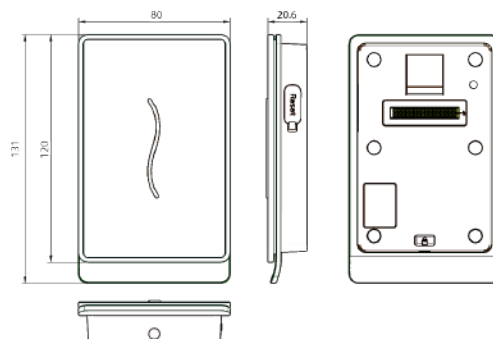

ZKTECO CO.,LTD.

www.zkteco.com

E-mail: sales@zkteco.com



Copyright © 2019 ZKTECO CO., LTD. All rights reserved.

V3.0 2019.01.10