

USER MANUAL

AL20B Fingerprint Lock with Touch Keypad

Version: 1.0

Date: November, 2017

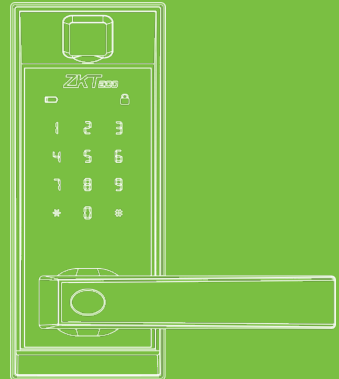

Table of Contents

Read Before Use	1
Safety Precautions	1
Structure	2
Basic Function	3
User Introduction	3
Initialization	4
Random Password.....	4
Voice Guide	5
Volume setting.....	5
Language setting	5
Lockout mode	5
Normal Open	6
Low Battery Warning	6
9V External Battery	7

How to change handle direction.....	8
Emergency Mechanical Key	9
How to Use	10
Register First Administrator	10
Register Other Administrator	12
Register Normal User	13
Delete Admin	14
Delete Normal User	15
Back up enroll	16
Volume setting	17
Language setting	18
Lockout mode	19
Normal open mode	20

Safety Precautions

1. The factory setting of all new locks will allow **ANY** fingerprints to open them.
2. Please register at least one administrator for the newly installed lock. The lock cannot register any normal users without an administrator.
3. The lock is equipped with mechanical keys for manual unlocking. Please keep the mechanical keys at a safe place.
4. To power ON the lock, four alkaline AA batteries (not included) are required. Non-alkaline and rechargeable batteries **ARE NOT RECOMMENDED**.
5. Do not remove batteries when the lock is in working state.
6. Please replace the battery soon when the lock prompts of low battery.
7. If the lock does not have any activity for seven seconds it will go into sleep mode and prompts of time expired.
8. For best results, apply clean fingers to the fingerprint sensor.

Structure

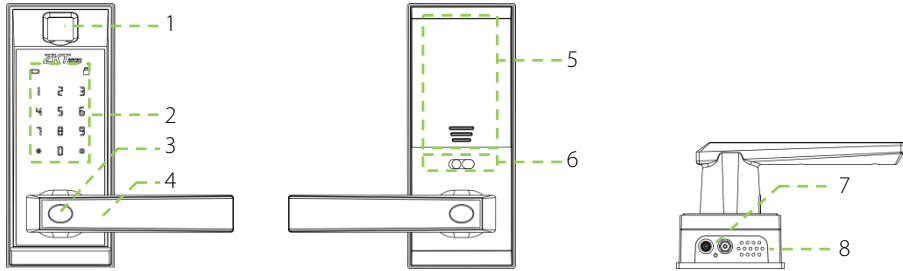

- 1. Fingerprint Sensor
- 2. Keypad & Card Detection Area
- 3. Mechanical Key Hole
- 4. Handle

- 5. Battery Area
- 6. Lockout Switch
- 7. 9V Battery Interface
- 8. Speaker

Basic Function

User Introduction

Group	Verification Mode	Function	Capacity
Administrator	Fingerprint	Register / Delete User, Open The Door, Access in menu	Max.100
	Password		Max.100
Normal User	Fingerprint	Open the door	Max.100
	Password		Max.100

Note:

1. The maximum fingerprint/password capacity is 100 for all groups.
2. The length of password is six digits.

Initialization

Initializing the lock means all data will be delete and restore to factory default setting.

Operation steps: Press the reset button on the back body of the lock, then touch the keypad to power on the lock holding the reset button for 5 seconds until the lock prompts the voice of “Restore to default settings, wait a moment”. After around 30 seconds, the lock prompts the voice of “completed”, and then the initialization is finished completely.

Random Password

Random password = Users may enter any number of random digits before or after the correct six digit password as long as the maximum number of digits entered is 32 or less.

For example: If the correct password is 123456, the random password can be 89123456807, 1234562363, 389123456, etc.

Voice Guide

After accessing the menu, the lock provides voice prompts before and after each operation for easy configuration.

Volume Setting

The lock volume can be set, which has three modes, high volume mode, low volume mode and silent mode.

Language Setting

Supports English / Spanish.or English / Portuguese.

Lockout Mode

When the lock set as lockout mode, only administrator can open the door, and also can use the **Lockout Switch** to enable or disable the mode.

Normal Open

Normal open mode is to keep door always unlocked, which is fit for meeting room and some places free to in or out.

Low Battery Warning

When the lock has a low battery a short beep and voice prompt of "Battery is low, please replace" will be prompted".

Note: Access to menu steps is not allowed in low battery status.

9V External Battery

9V external battery is used to open doors in emergency.

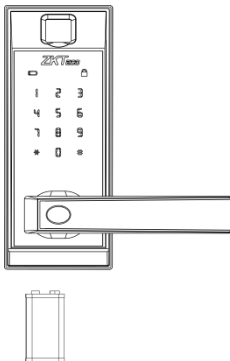

Note: The above battery must be 9V alkaline battery (6LR61).

How To Change Handle Direction

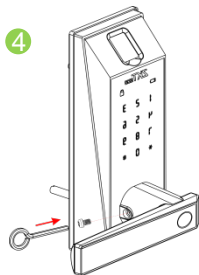
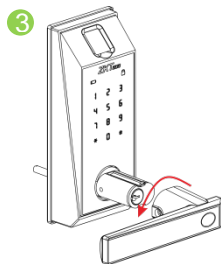
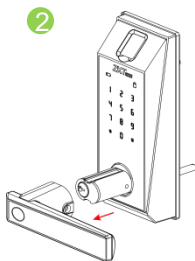
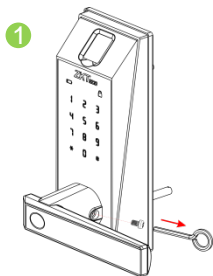

Step:

1. Remove the screws with a screwdriver.
2. Take out the lock handle.
3. Turn the handle in the opposite direction.
4. Replace the screws.

Emergency Mechanical Key

The mechanical key is used to open door when the lock has electronic malfunction.

Note: Keep the mechanical key at a safe place.

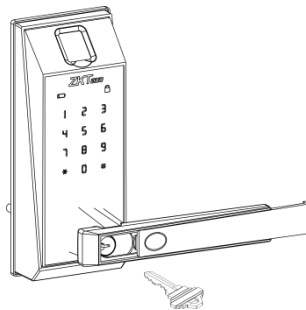

Register First Administrator

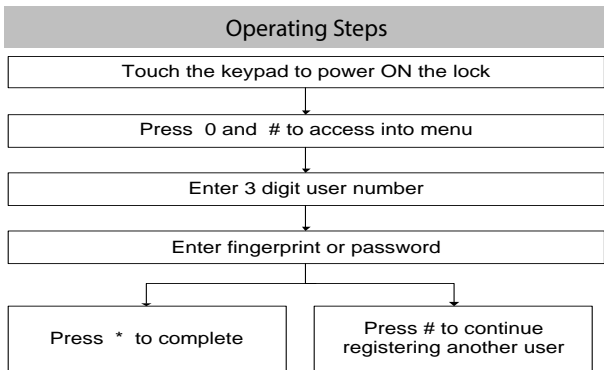

Note:

1. Place one finger three times on fingerprint sensor to register fingerprint.
2. The length of password should be of six digits.
3. Default user number length is three digits, but one or two digit user numbers are accepted by pressing the # key.
4. Press * to cancel registration before the registration is complete.

Register Other Administrator

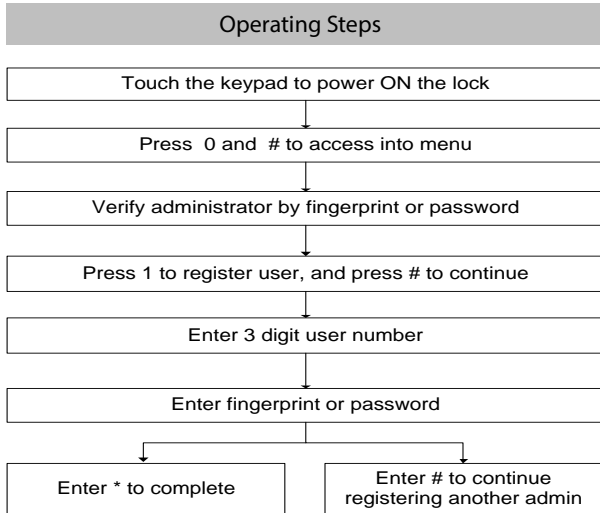

Note: If you verify administrator by password, please end with button #.

Register Normal User

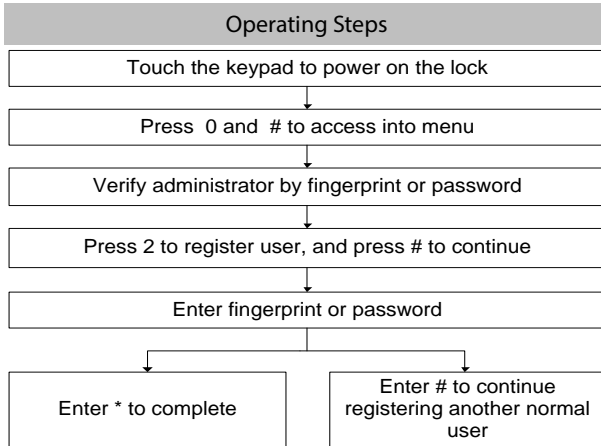

Delete Admin

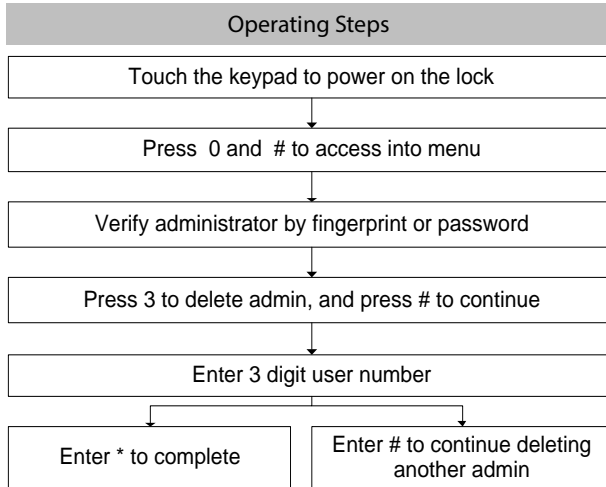

Delete Normal User

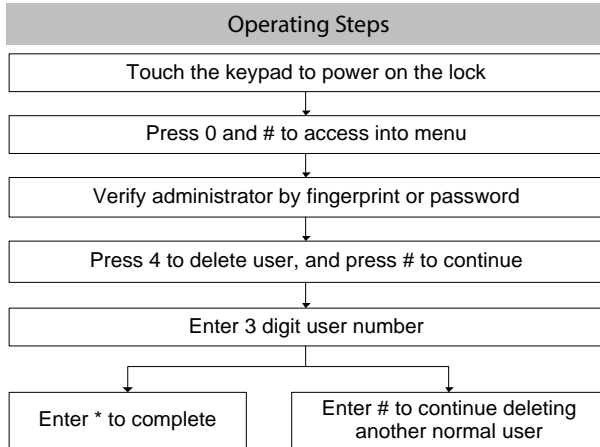

Back Up Enroll

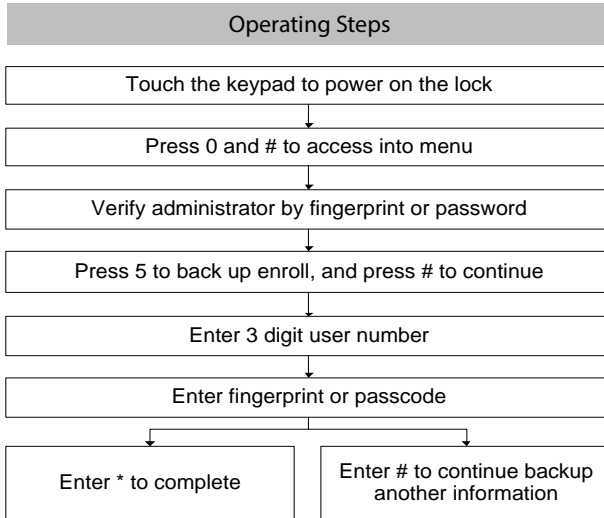

Volume Setting

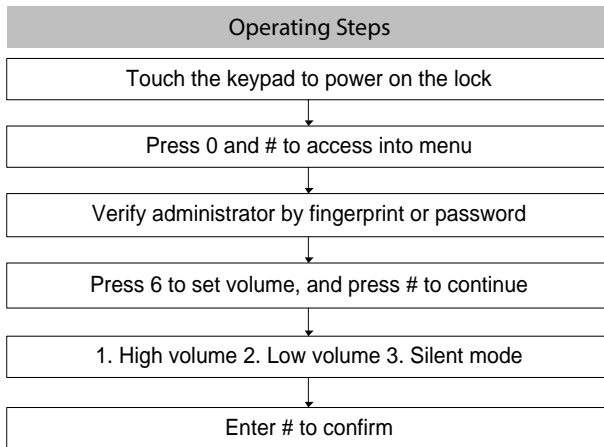

Language Setting

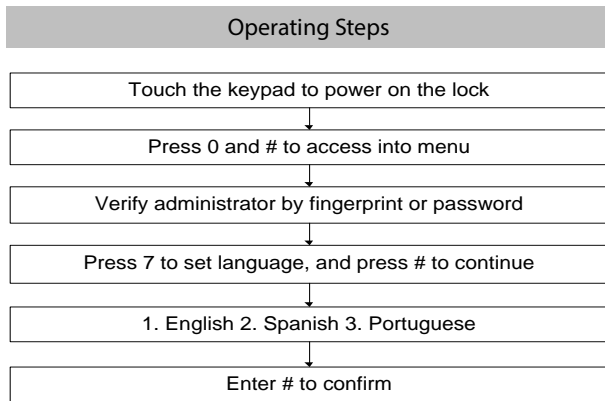

Note: There are only two language mode, English/Spanish, or English/Portuguese. For example, if the lock is equipped with English/Spanish, selecting "3" (Portuguese), will still show Spanish mode.

Lockout mode

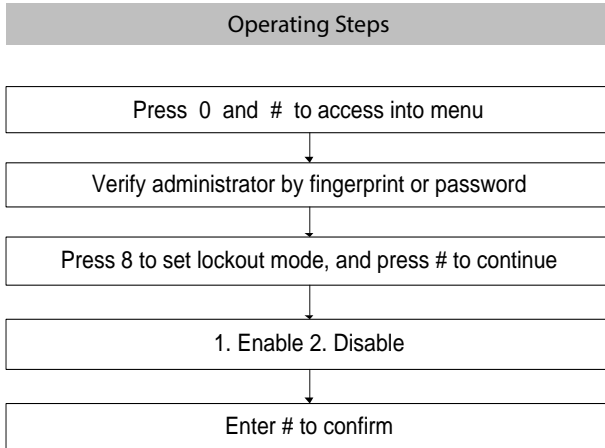

Normal open mode

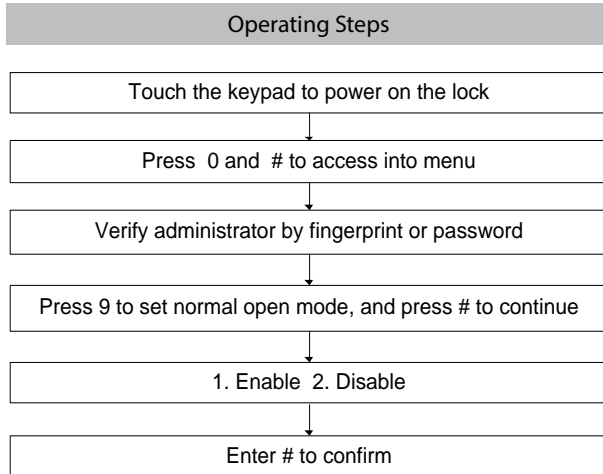

ZK Building, Wuhe Road, Gangtou, Bantian, Buji Town,
Longgang District, Shenzhen China 518129
Tel: +86 755-89602345
Fax: +86 755-89602394
www.zkteco.com

