

# User Manual

PL10/ML10

---

Version: 2.0

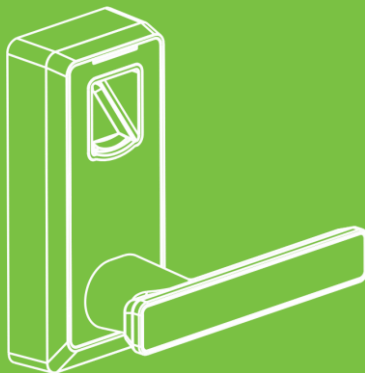

## Remarks

1. New lock is configured to grant any fingerprint access.
2. The lock is equipped with mechanical keys for manual unlocking. Remove mechanical keys from the package and keep them in a safe place.
3. To power up the lock, four alkaline AA batteries (not included) are required. Non-alkaline and rechargeable batteries are NOT recommended.
4. Press the fingerprint sensor or the sensor holder to power up the lock. To avoid unlocking the door when pressing the fingerprint sensor, pressing the sensor holder to power up the lock is recommended.
5. The operation of lock setting has a stand-by time limit of 10 seconds; if there is no any activity, the lock will shut off after 10 seconds.
6. Keep your fingers clean when using this lock.

# Appearance

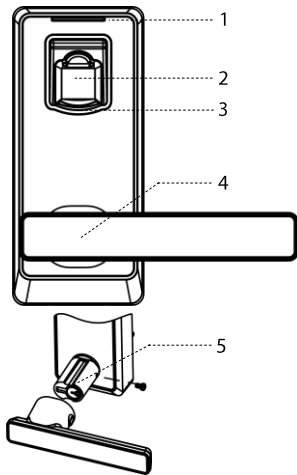

- 1 LED
- 2 Fingerprint Sensor
- 3 Sensor Holder
- 4 Handle
- 5 Mechanical Key Hole
- 6 Battery Box Cover
- 7 Battery Area
- 8 Button ③ / Temporary User
- 9 Button ① / Admin user
- 10 Back LED
- 11 Button ⊖ / Delete user
- 12 Button ⊕ / Add user
- 13 Reset Button
- 14 Button ② / Normal User
- 15 9V Emergency Battery Interface

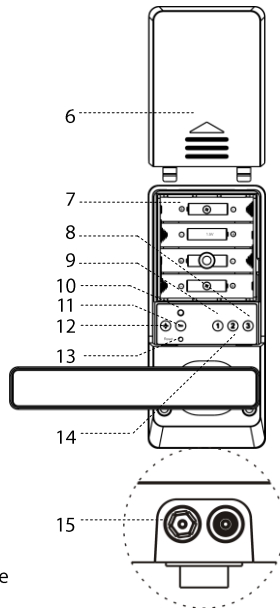

# Profile

## User Introduction

User Type	Capacity	Privilege
Administrator	10	Add/delete fingerprint; Enable Normally Open (NO) mode; Unlock the door
Normal User	60	Unlock the door; Enable NO mode
Temporary User	20	Unlock the door; Enable NO mode

## Button Definition

Buttons	Function	Other functions
⊕	Add Users	
⊖	Delete Users	
①	Administrator User Group	Enable NO mode
②	Normal User Group	Enable NO mode
③	Temporary User Group	Enable NO mode

## Lock Status Indication

Lock Status	Indication
Successful Operation	1 beep and LED blinks in green
Failed Operation	2 beeps and LED blinks in red
Low battery	7 beeps and LED blinks in red for 7 times
Unlocking	1 beep and electric engine makes a rolling sound for the first time, which indicates that the door is open.
Locking	Electric engine makes a rolling sound for the second time, which indicates that the door is closed.

## Lock Initialization

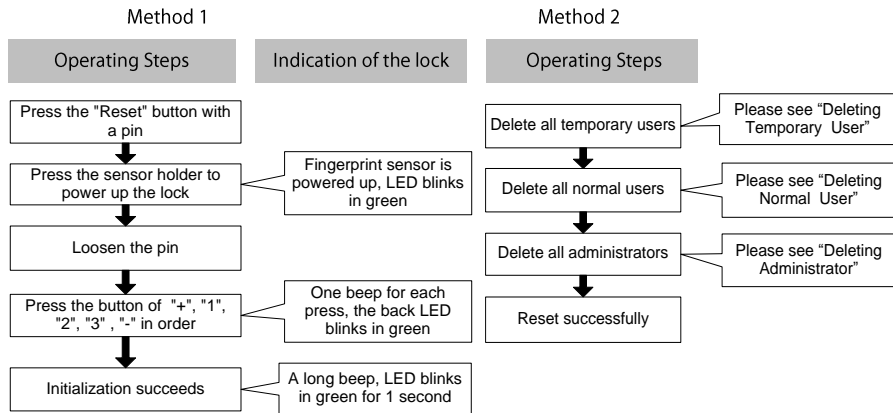

**Note:** The lock will be restored to factory defaults after initialization, and the door can be opened with any fingerprint.

How to use mechanical key?

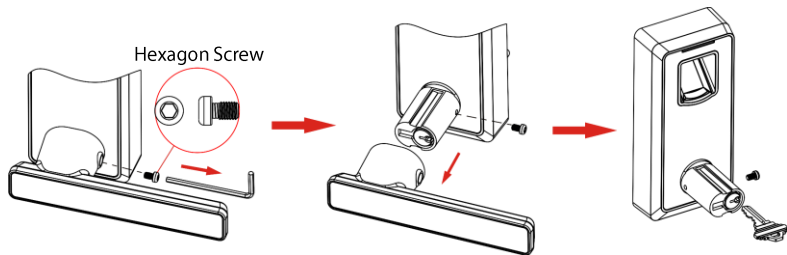

How to use 9V emergency battery?

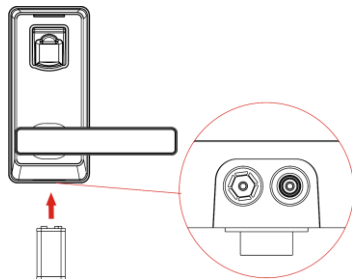

## Registering First Administrator

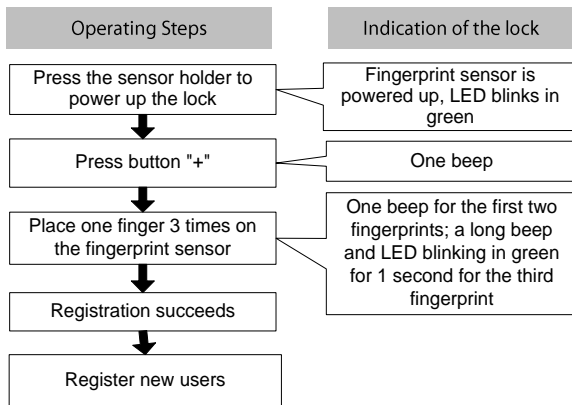

- Note:**
1. The first user will be the first administrator automatically in default setting.
  2. Admin group supports 10 users; you can still register 9 new administrators in the next step.
  3. The operating steps of registering new users: press button 1/2/3 to select user group, and then place one new finger 3 times on the fingerprint sensor for registration. You can continue registering new user afterwards.



## Registering Other Administrators

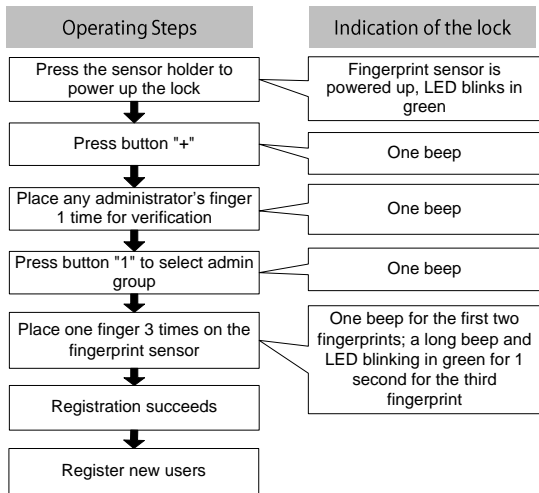

**Note:** Admin group supports 10 users; you can still register 9 new administrators in this step.

# Registering Normal User

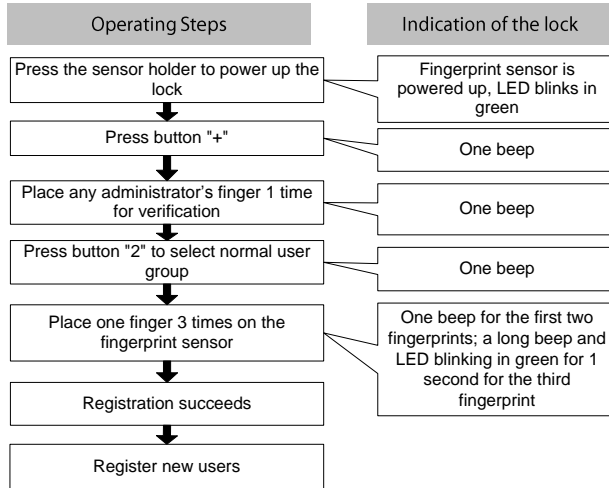

**Note:** Normal user group supports 60 users.

## Registering Temporary User

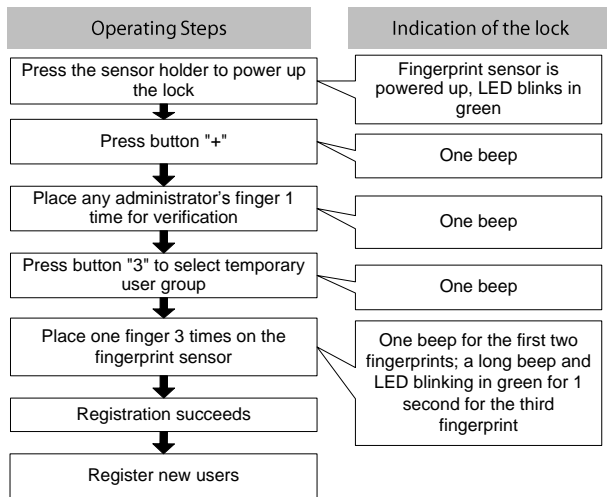

**Note:** Temporary user group supports 20 users.

## Deleting Temporary User Group

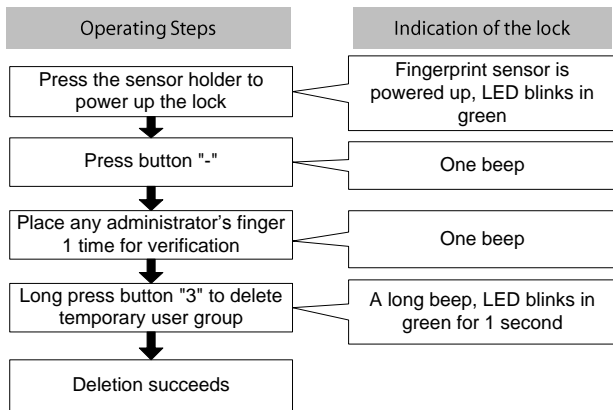

**Note:** Deleting operation is only valid for groups.

## Deleting Normal User Group

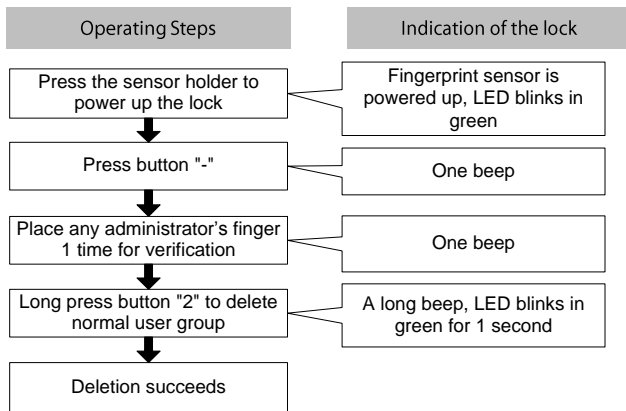

**Note:** Deleting operation is only valid for groups.

## Deleting Admin Group

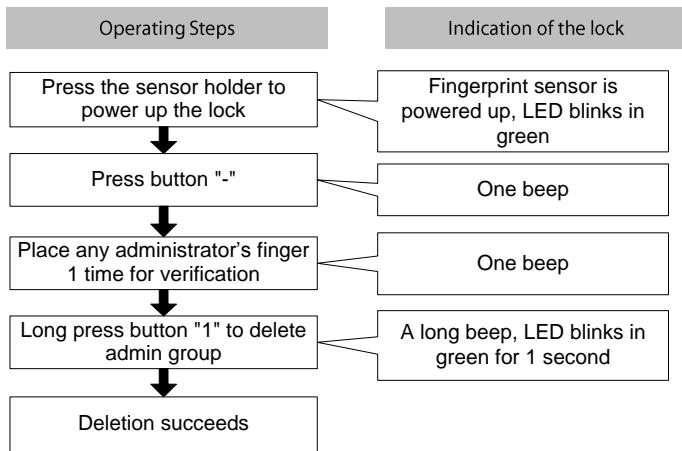

**Note:** Deleting operation is only valid for groups.

## Enabling/Disabling Normally Open Mode

Enabling Normally Open Mode:

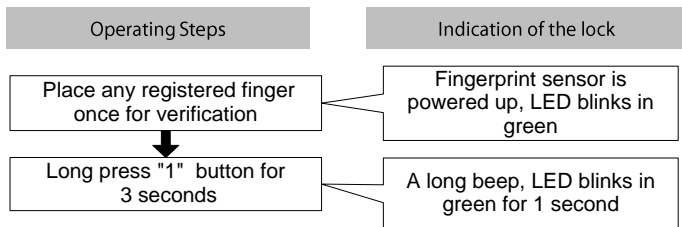

### **Disabling Normally Open Mode:**

Place any registered finger for 1 time to disable it.